

Keys Business Village

Hednesford, Cannock

To Let



Workspace units
1,534 - 2,685 sq ft

networkspace

Keys Business Village

Hednesford, Cannock

The Site

- Workspace units ranging from 1,534 – 2,685 sq ft
- Warehouse lighting and heating
- Full height motorised doors
- Some units have an office
- Individual alarms
- CCTV / gate access control
- On site parking
- BREEAM 'Very Good' rating
- Access to the centrix centre meeting and conference rooms (chargeable)

The Details

- Competitive rents
- Flexible terms available
- Internal repairing lease

The Location

- Keys Business Village is located on Keys Park Road in Hednesford, Staffordshire, which is north of Cannock and accessible from Junctions 11 and 12 of the M6 motorway, and Junction 7 of the M6 Toll.
- Keys Business Village, Keys Park Road, Hednesford WS12 2HA

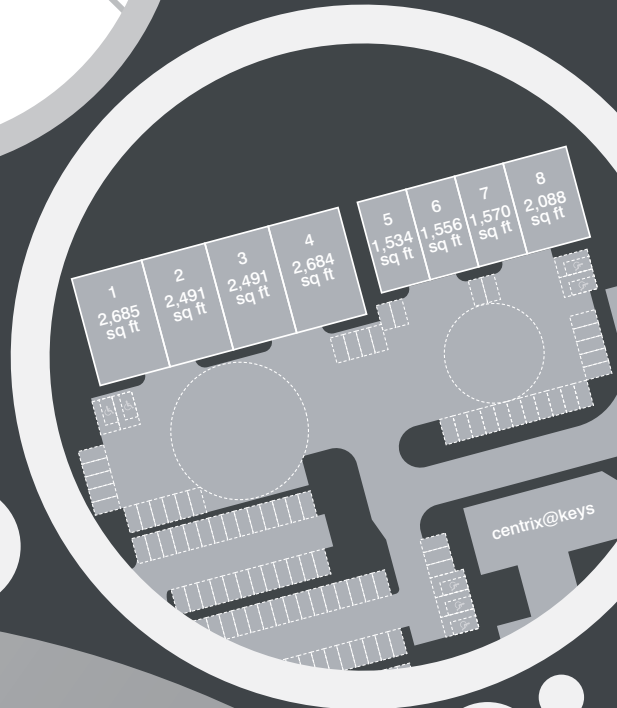

A joint venture between

networkspace

langtree



Homes & Communities Agency

01543 478700

www.networkspace.co.uk

The Agents for themselves and for the Seller/Lessor of this property who agents they are give notice that: 1. These particulars do not constitute any part of an offer or a contract. 2. All statements contained in these particulars are made without responsibility on the part of the Agent(s) or the Seller/Lessor. 3. None of the statements contained in these particulars is to be relied upon as a statement or representation of fact. 4. Any intending Buyer or Tenant must satisfy himself by inspection or otherwise as to the correctness of each of the statements contained in these particulars. 5. The Seller/Landlord does not make or give and neither the Agent(s) nor any person in their employment has any authority to make or give any representation or warranty whatever in relation to this property. November 2011.

Designed by Future 01925 638 581 www.futuredc.co.uk